

nicchie

singole

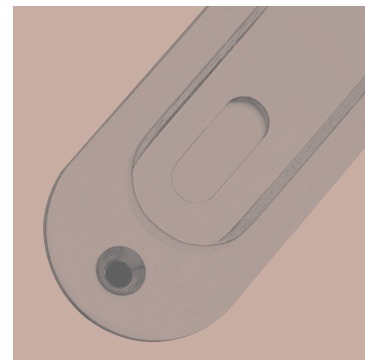

04140



4011S

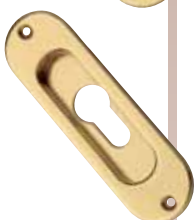

04141



04139

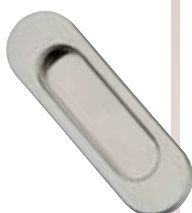

04139A



133CF



133SF



135CF

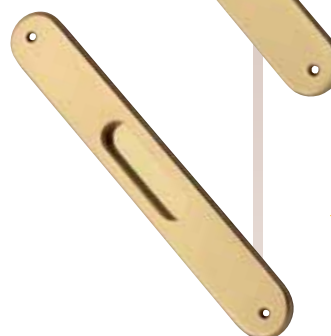

135SF

- Art. 04140** NICCHIA OVALE CON FORO CENTRALE
oval niche with central hole
- Art. 4011S** NICCHIA OVALE CON FORO BASSO
oval niche with low hole
- Art. 04141** NICCHIA OVALE CON FORO YALE
oval niche with cylinder hole
- Art. 04139** NICCHIA OVALE SENZA FORO
oval niche without hole
- Art. 04139A** NICCHIA COPRIVATE IN ACCIAIO INOX
niche without screw-holes (stainless steel)
- Art. 133CF** NICCHIA OVALE A FILO (SENZA INCASSO) CON FORO CHIAVE
oval niche to apply (without milling) with key hole
- Art. 133SF** NICCHIA OVALE A FILO (SENZA INCASSO) SENZA FORO CHIAVE
oval niche to apply (without milling) without key hole
- Art. 135CF** NICCHIA LUNGA CON FORO CHIAVE
long niche with key hole
- Art. 135SF** NICCHIA LUNGA SENZA FORO CHIAVE
long niche without key hole



O.L.V.



O.S.V.



O.F.G.



O.C.R.



O.C.R.S.



O.N.I.K.S.



O.A.P.



O.V.N.

nicchie

singole



4095S

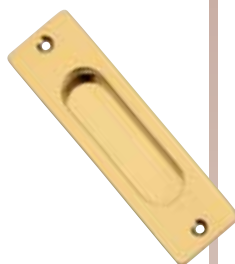

4093S

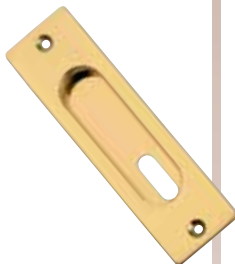

4091S



4094S



4109S

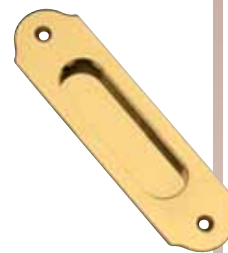

4108S



4106S



4107S

- Art. 4095S** NICCHIA RETTANGOLARE CON FORO YALE
rectangular niche with cylinder hole
- Art. 4093S** NICCHIA RETTANGOLARE SENZA FORO
rectangular niche without hole
- Art. 4091S** NICCHIA RETTANGOLARE CON FORO BASSO
rectangular niche with low hole
- Art. 4094S** NICCHIA RETTANGOLARE CON FORO CENTRALE
rectangular niche with central hole
- Art. 4109S** NICCHIA RETTANGOLARE SAGOMATA CON FORO YALE
rectangular classic niche with cylinder hole
- Art. 4108S** NICCHIA RETTANGOLARE SAGOMATA SENZA FORO
rectangular classic niche without hole
- Art. 4106S** NICCHIA RETTANGOLARE SAGOMATA CON FORO BASSO
rectangular classic niche with low hole
- Art. 4107S** NICCHIA RETTANGOLARE SAGOMATA CON FORO CENTRALE
rectangular classic niche with central hole



O.L.V.



O.S.V.



O.F.G.



O.C.R.



O.C.R.S.



O.N.I.K.S.



O.A.P.



O.V.N.

nicchie

singole

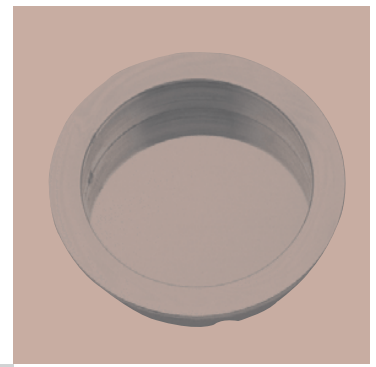

4031S

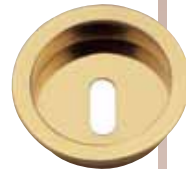

4026S



4033S



4035S



4024S



00S18



0S18P



O.L.V.



O.S.V.



O.F.G.



O.C.R.



O.C.R.S.



O.N.I.K.S.



O.A.P.



O.V.N.

- Art. 4031S** NICCHIA TONDA Ø 57 MM, SENZA FORO CHIAVE
round niche Ø 57 mm, without key hole
- Art. 4026S** NICCHIA TONDA Ø 57 MM, CON FORO CHIAVE
round niche Ø 57 mm, with key hole
- Art. 4024S** NICCHIA TONDA Ø 57 MM, CON FORO YALE
round niche Ø 57 mm, with cylinder hole
- Art. 4033S** NICCHIA TONDA Ø 40 MM, SENZA FORO CHIAVE
round niche Ø 40 mm, without key hole
- Art. 4035S** NICCHIA TONDA Ø 30 MM, SENZA FORO CHIAVE
round niche Ø 30 mm, without key hole
- Art. 00S18** DITALE DI TRASCINAMENTO
finger slide
- Art. 0S18P** DITALE DI TRASCINAMENTO (CORPO IN PLASTICA)
finger slide (plastic body)

nicchie

singole

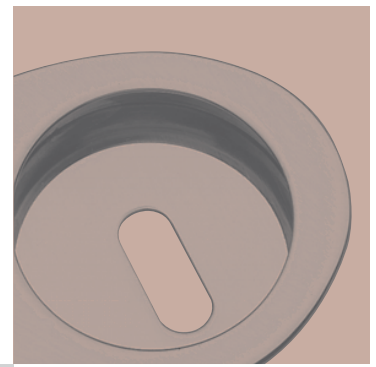

4059S



4061S



4058S



4065S



4067S



4069S



4117S



4121S



4123S



O.L.V.



O.S.V.



O.F.G.



O.C.R.



O.C.R.S.



O.N.I.K.S.



O.A.P.



O.V.N.

- Art. 4059S** NICCHIA ELLITTICA, SENZA FORO CHIAVE
elliptical niche, without key hole
- Art. 4061S** NICCHIA ELLITTICA, CON FORO CHIAVE
elliptical niche, with key hole
- Art. 4058S** NICCHIA ELLITTICA, CON FORO YALE
elliptical niche, with cylinder hole
- Art. 4065S** NICCHIA QUADRATA, SENZA FORO CHIAVE
square niche, without key hole
- Art. 4067S** NICCHIA QUADRATA, CON FORO CHIAVE
square niche, with key hole
- Art. 4069S** NICCHIA QUADRATA, CON FORO YALE
square niche, with cylinder hole
- Art. 4117S** NICCHIA QUADRATA SAGOMATA CIECA
classic square niche without hole
- Art. 4121S** NICCHIA QUADRATA SAGOMATA CON FORO CHIAVE
classic square niche with key hole
- Art. 4123S** NICCHIA QUADRATA SAGOMATA CON FORO YALE
classic square niche with cylinder hole

measure

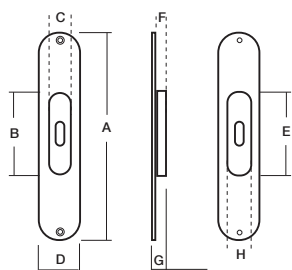

NICCHIA OVALE / OVAL		A	B	C	D	E	F	G	H
Art. 04000 - 04001 - 04002 - 04003 04010 - 04011 - 04012 - 04016 04140 - 04139 - 04141 - 4011S	mm.	120	78	21	34	85	9	11	25
Art. 133CF - 133SF	mm.	125	76	21	34	-	-	10	-
Art. 135CF - 135SF	mm.	250	73	19	38	83	5	10	25
Art. 4139A	mm.	125	80	24	39	85	9	13	30

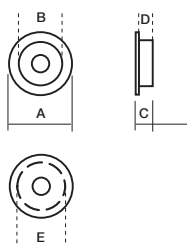

NICCHIA TONDA/ ROUND		A	B	C	D	E	F	G	H
Art. 04020 - 04021 - 04022 - 04023 04072 - 04073 - 04026 - 04027 04031 - 4031S - 4026S - 04036 04037	mm.	57	40	12	10,5	48	-	-	-
Art. 04070-04071	mm.	48	39	12	8	41			
Art. 4033S	mm.	40	25	12	10,5	35	-	-	-
Art. 4035S	mm.	30	20	12	10,5	26,5	-	-	-
Art. 00S18	mm.	29	19	20	18	25	-	-	-

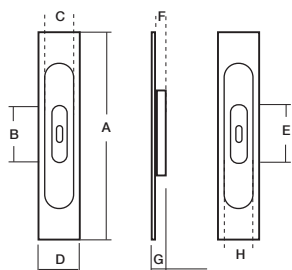

NICCHIA RETTANGOLARE / RECTANGULAR		A	B	C	D	E	F	G	H
Art. 04085 - 04086 - 04088 - 04089 04092 - 04091 - 04093 - 4095S 4093S - 4091S - 4094S	mm.	120	72	20	34	80	9	11	25
NICCHIA RETTANGOLARE CLASSICA CLASSIC RECTANGULAR NICHE		A	B	C	D	E	F	G	H
Art. 04100 - 04101 - 04102 - 04103 04107 - 04106 - 04104 - 4109S 4108S - 4106S - 4107S	mm.	128	72	20	34	80	9	11	25

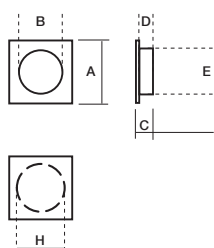

NICCHIA QUADRATA / SQUARE		A	B	C	D	E	F	G	H
Art. 04050 - 04051 - 04052 - 04053 04080 - 04081 - 04083 - 04084 04068 - 40367 - 4026S - 4065S 4067S - 4069S	mm.	59	40	12	10	48	-	-	48
NICCHIA QUADRATA CLASSICA CLASSIC SQUARE NICHE		A	B	C	D	E	F	G	H
Art. 04110 - 04111 - 04112 - 04113 04115 - 04116 - 04125 - 04126 04122 - 04121 - 04117 - 4117S 4121S - 4123S	mm.	80	40	12	10	48	-	-	48

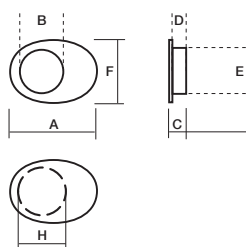

NICCHIA ELLITTICA / ELLIPTICAL		A	B	C	D	E	F	G	H
Art. 04054 - 04055 - 04056 04057 - 04077 - 04078 04060 - 04061 - 04062 04059 - 4059S - 4061S 4058S	mm.	80	40	11	9	48	57	-	48